

## SPECIFICATIONS

Frequency Response	100Hz-20KHz
Sensitivity	90±3dB
Rated Power	30W
Power Taps	15W/30W
Line input	100V
Dimension(mm)	493*152*100
<b>Physical Specification</b>	
Material	Aluminium( white ral 9016)
Grill	Aluminium( white ral 9016)
Component	4" Full Range Speaker
Finished Colour	White ral 9016
Unit Weight	3.32Kg
Gross Weight	7.2Kg/2PCS
Packing Dimension(cm)	53*34*13
<b>Speaker Specification</b>	
Voice Coil Size	Φ0.12*2Layer
DC Impedance	7.2Ω
Former	Kapton
Magnet	Ferrite(197g)Φ70*Φ32*10(Y30)
Basket	Iron
Cone Material	Paper Coat
Spider	Cloth
Dust cap	Mylar
Net Weight	400g

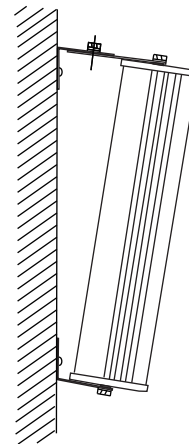

CS-413

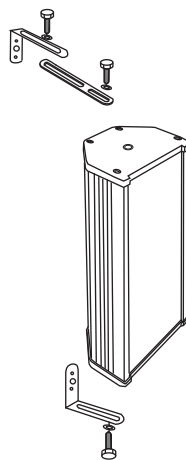
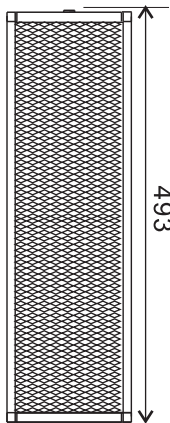
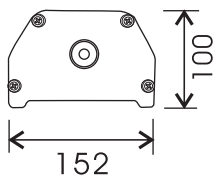
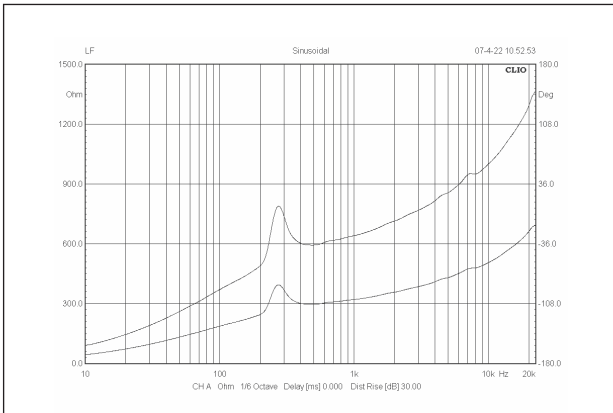
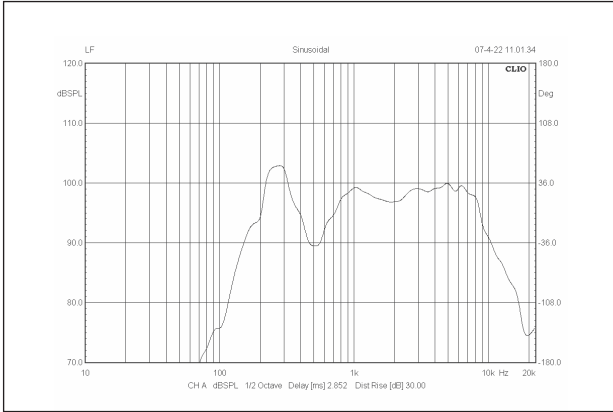

Horizontal

Vertical

